

Key Plan

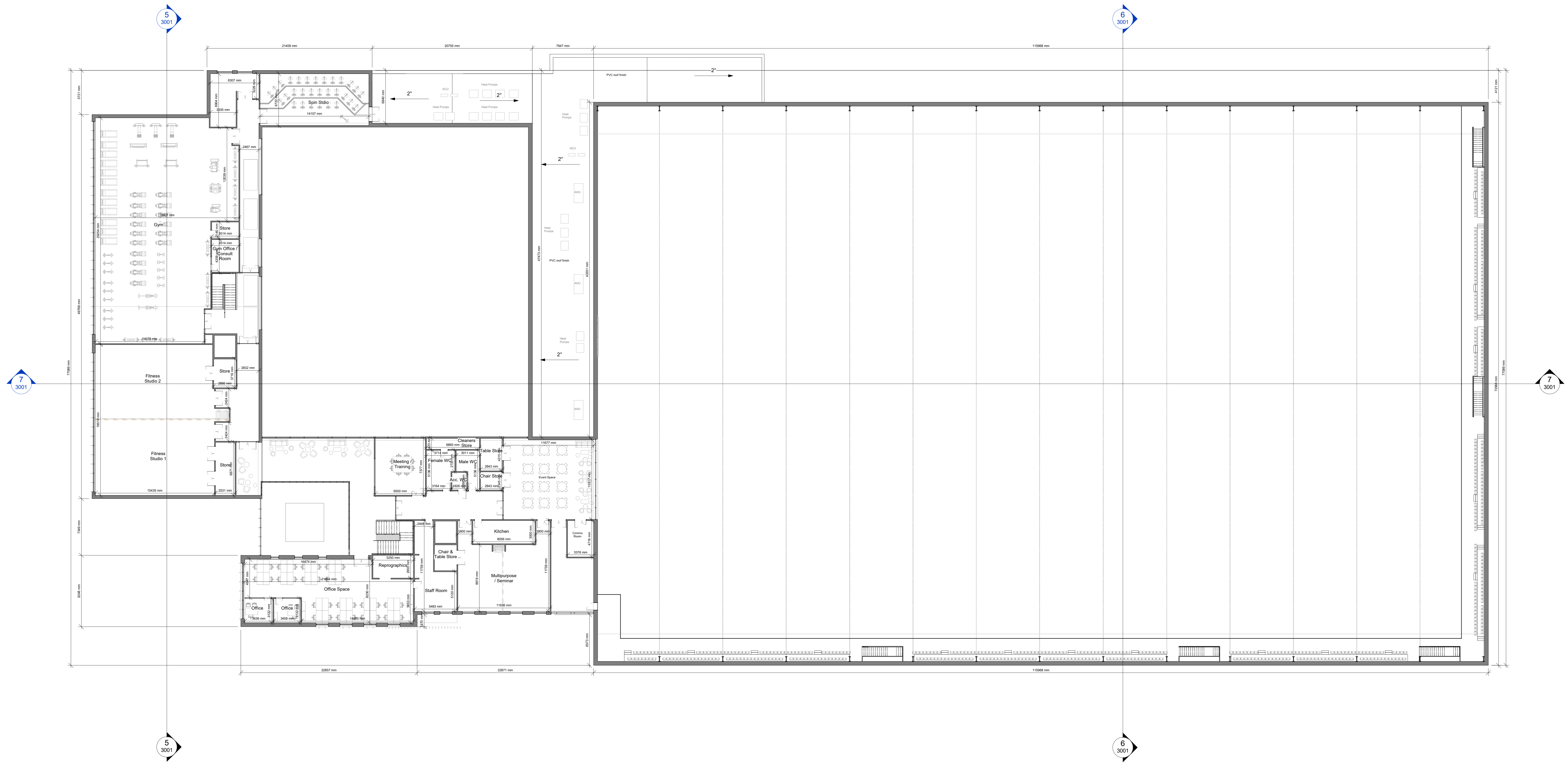

1 Plan - Sports Building - Level 01
 2002 Scale: 1 : 200

Rev	Issue Date	Issued for Planning	Description	By
Project Status: PLANNING ISSUE				
Client: Cavan County Council				
Project: Cavan Regional Sports Campus				
Drawing: Plan - Sports Building - Level 01				
Scale: @ A0 1 : 200				
				1c Montgomery House, 478 Castlemeath Road, Belfield, BT15 6DD T: 028 9040 2000 admin@mcadamdesign.co.uk www.mcadamdesign.co.uk
McAdam Design Project Number:	A2156			
Drawn	Author	Checked	Checker	Approver
Date	Date	Date	Date	Date
Drawing No: CSC-MCA-XX-01-DR-A-2002				Scale: S4
All dimensions are in millimetres. Figured dimensions to be taken in preference to scale dimensions. Dimensions to be checked on-site. © 2020 McAdam Design Ltd.				Plot Date: 08/03/2024 10:41:44